

DIAMOND ROAD SAFETY SDN BHD

Retro-Reflective Signage

Traffic signs are used to provide guidance and warnings necessary to road users. The increased volume of vehicles on our roads and highways today has made driving conditions more complex.

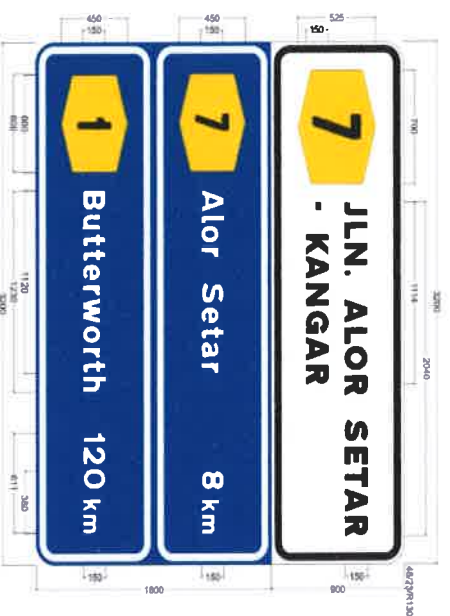
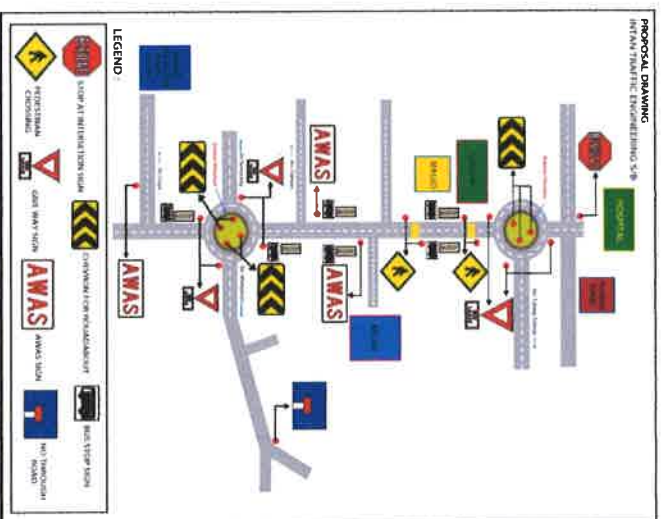

Therefore, the requirements for adding more traffic signs are exacting. Our retro-reflective signage provides the benefits listed below.

- = Long Durability
- = High Visibility during day and night
- = Superior Brightness

Diamond Road Safety is committed to

- = Conforming to standard traffic signage specifications in accordance with Arahan Teknik from JKR.
- = Producing high quality traffic signs to improve road safety awareness and encourage the adherence to road rules
- = Ensuring and monitoring product warranty performance to safeguard government and public interest.



Material -

High Intensity Retro-Reflective Prismatic (HIP) sheeting.

Wong Yat Meng
Contract Manager

☎ +60 19 372 2116
✉ ymwong@diamonddroadsafety.com

DIAMOND ROAD SAFETY SDN. BHD. (Persendirian)

No. 65, Jalan TRP-1/1, Taman Perindustrian Puchong, Seksyen 1,
47100 Puchong, Selangor Darul Ehsan, Malaysia.
T +60 3 8066 2865 / 8066 8075 F +60 3 8066 8079